

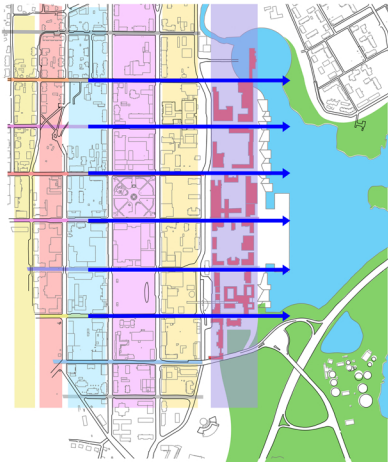

AHSIRT1987

Satamalahti **the true reflection of the city**



Plan

Parallel bands of blocks are extended by adding one more band on Lake Front. The character, grain, scale remains largely unaltered. All cross roads lead to lake like it is now.

No longitudinal development is proposed as the compressed lake front is enough for 1,00,000 people even. Instead as extensions of city centre the bird sanctuary is pulled up and increased three times. All other lake edges are proposed to be wild and left to nature.



Satamalahti the true reflection of the city
the making

Premise
Any new large development on a waterfront becomes a barrier between existing city and the waterfront. Challenge is to create a water front without disturbing this vital connection.

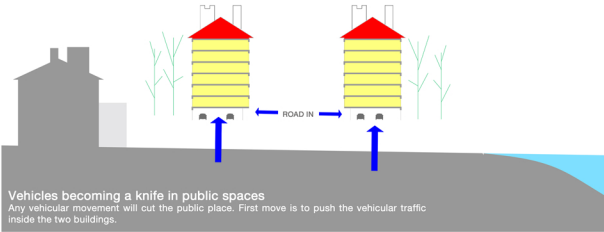
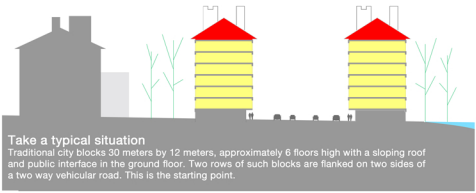

Satamalahti **the true reflection of the city**
the making

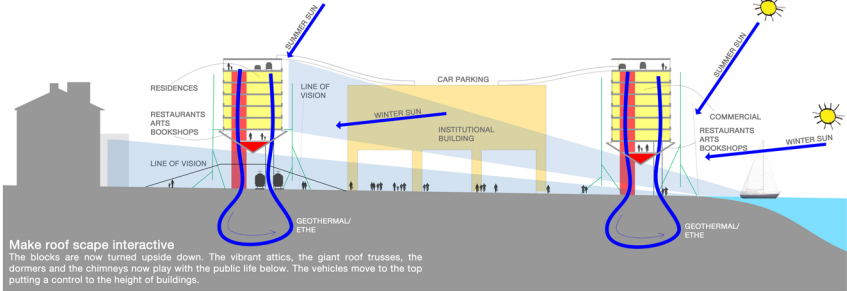
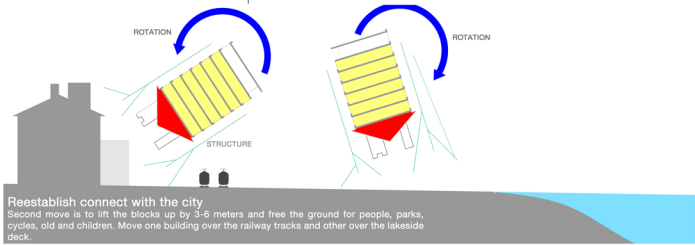

The ground has been cleared. These columns carry warm air into the buildings, while minimum damage on ground. The road and parking on top relieves the lake front free of vehicles. City reconfirms its connection to the lake front.



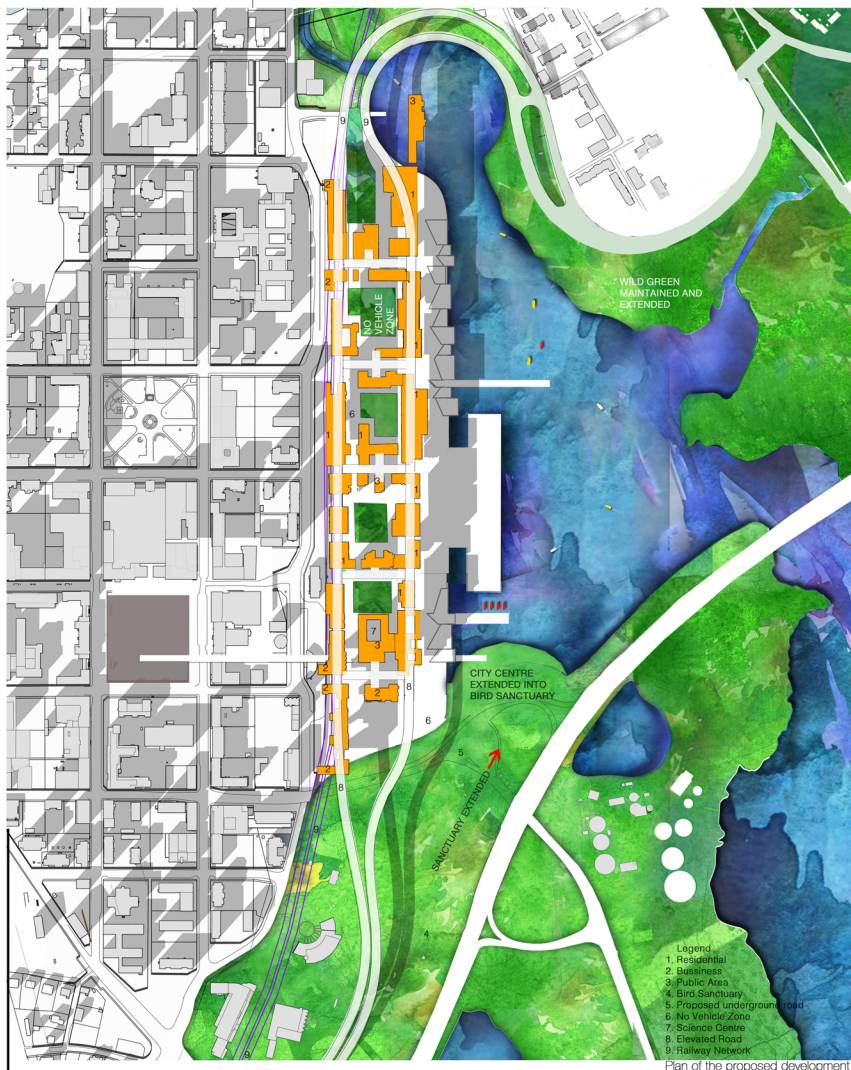

Plan of the proposed development





aerial view from the highway

Satamalahti the true reflection of the city
the grain

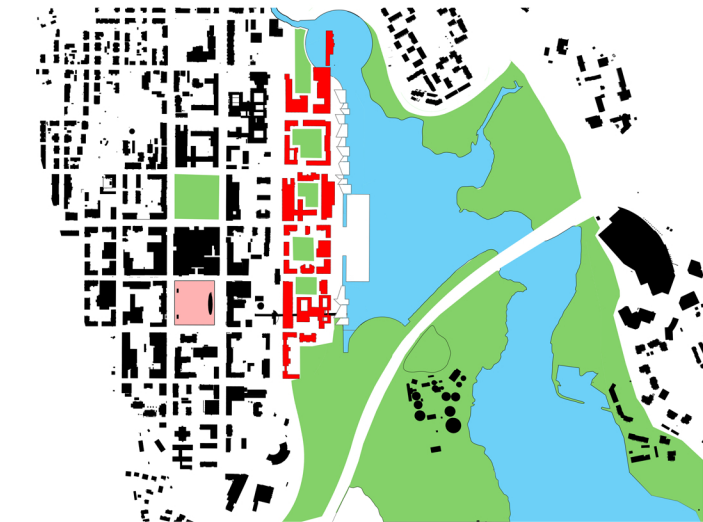

granularity plan



cross section



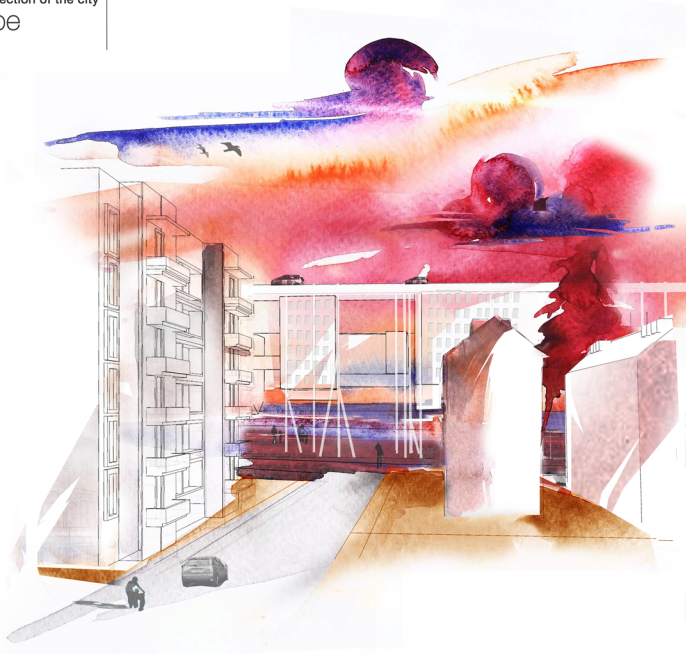

Uninterrupted view of the lake from the existing city

Kortteli -The conventional city block
Taken and overturned so as to make the
otherwise invisible high rise roofscape
genuinely interactive with the public life, and
frees the ground





View from the harbour

Kantele -Finnish musical instrument

Used for the wooden deck of the lakeside, as if music frozen in time. Made of reusable wood, it gently slopes down and interlocks with the water to become a seamless whole when the lake is frozen.





View towards Satamalahti from across the lake

Ruoko -Winter reed

The inspiration for the design of a lightweight slender construction system for the blocks, as if growing out of the lake

